

**OWNER**  
MINNESOTA VIKINGS FOOTBALL, LLC  
600 VIKING DR., EDEN PRAIRIE, MN 55344

**ARCHITECT / INTERIORS / BRANDING**  
HKS, INC.  
3601 ST. PAUL ST., SUITE 100, DALLAS, TX 75201

**ASSOCIATE ARCHITECT - SKIN**  
STUDIO FIVE ARCHITECTS  
322 FIRST AVE. N. SUITE 400, MINNEAPOLIS, MN 55401

**ASSOCIATE ARCHITECT - INTERIORS**  
STUDIO HIVE  
901 NORTH 3rd ST., SUITE 228, MINNEAPOLIS, MN 55401

**MEP / TECHNOLOGY / LIGHTING**  
M.E. ENGINEERS, INC.  
10555 WEST 43rd AVE., WHEAT RIDGE, CO 80033

**STRUCTURAL ENGINEER**  
THORNTON TOMASETTI  
12750 MERIT DR., SUITE 750, LB-7, DALLAS, TX 75251

**CIVIL ENGINEER**  
EVS, INC.  
10255 VALLEY VIEW, SUITE 123, EDEN PRAIRIE, MN 55344

**LANDSCAPE ARCHITECT**  
OSLUND AND ASSOCIATES  
115 WASHINGTON AVE. N., MINNEAPOLIS, MN 55401

**AUDIO VISUAL CONSULTANTS**  
ACUSTIC DIMENSIONS  
15088 WRIGHT BROTHERS DR., ADDISON, TX 75001

**W/WH**  
4801 SPRING VALLEY RD., DALLAS, TX 75244

**CODE / FIRE PROTECTION**  
FSC, INC.  
6225 INDIAN CREEK, SUITE 300, OVERLAND PARK, KS 66210

**FOOD SERVICE**  
RICCA NEWMARK  
5235 SOUTH VALENTIA, GREENWOOD VLG, CO 80111

**WAYFINDING**  
SEE BEST PRACTICE DESIGN  
432 CULVER BLVD., PLAYA DEL REY, CA 90293

**VERTICAL TRANSPORTATION**  
ELEVATOR ADVISORY GROUP  
14530 PENNOCOCK AVE., SAINT PAUL, MN 55124

**ADA CONSULTANT**  
ED ROTHER CONSULTING, LLC  
2990 MISSION BELLEVUE, LOUISBURG, KS 66663

**WIND / SNOW CONSULTANT**  
ROWAN WILLIAMS DAVIES AND IRWIN, INC.  
600 WOODLAWN RD., GUELPH, ON CANADA N1H 1B8

**BUILDING ENVELOPE CONSULTANT**  
THORNTON TOMASETTI - BUILDING SKIN PRACTICE  
300 N. WABASH AVE., SUITE 1500, CHICAGO, IL 60611

**FAÇADE ACCESS CONSULTANT**  
LEITCH BATES, INC.  
8089 LINCOLN ST., SUITE 105, LITTLETON, CO 80122



**REGISTRATION**  
I hereby certify that this plan, specification, or report was prepared by me or under my direct supervision and that I am a duly Licensed Architect under the laws of the State of Minnesota.

*Kevin A. Taylor*  
Kevin A. Taylor, AIA  
License No. 91015 02/13/2015

**KEY PLAN**

10	11	12	1
9	16	13	2
8	15	14	3
7	6	5	4

**REVISION**

NO.	DESCRIPTION	DATE
1	CCD-073	08/04/2014
2	CCD-080	06/13/2014
3	CCD-094	07/03/2014
4	CCD-105	07/26/2014
5	ASH-109	08/01/2014
6	ASH-124	08/29/2014
7	ASH-135	09/02/2014
8	ASH-139	10/03/2014
9	CCD-150	01/07/2014
10	CCD-227	05/15/2015
11	CCD-150.1	06/12/2015

HKS PROJECT NUMBER  
**16246.000**

DATE  
**MAY 02, 2014**

ISSUE  
**CCD-060**

SHEET TITLE  
**EVENT LEVEL - SECTOR 04**

SHEET NO.  
**A2.0104**

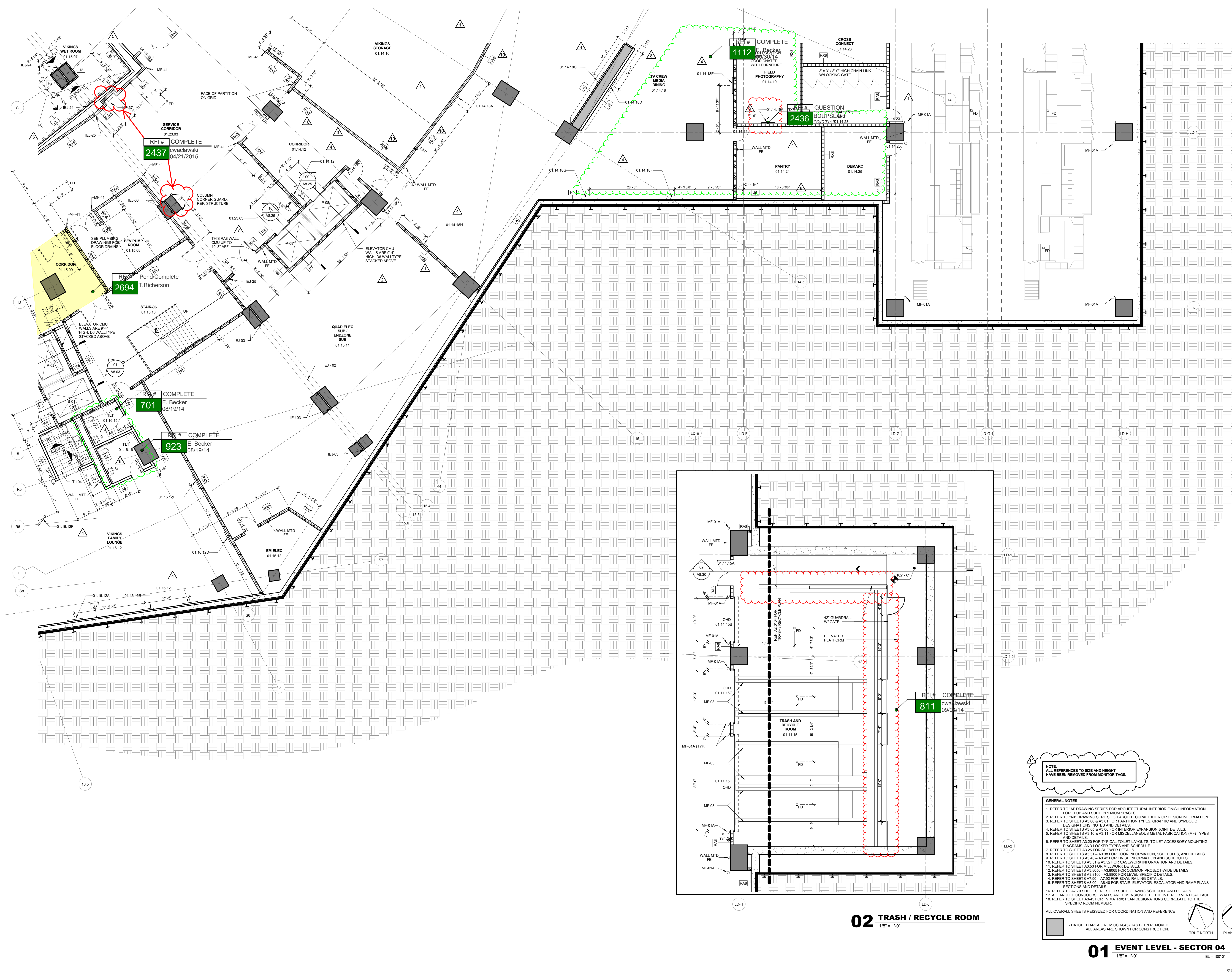

**NOTE:**  
ALL REFERENCES TO SIZE AND HEIGHT HAVE BEEN REMOVED FROM MONITOR TAGS.

**GENERAL NOTES**

- REFER TO "A" DRAWING SERIES FOR ARCHITECTURAL INTERIOR FINISH INFORMATION FOR CLUB AND SUITE PREMIUM SPACES.
- REFER TO "AV" DRAWING SERIES FOR ARCHITECTURAL EXTERIOR DESIGN INFORMATION.
- REFER TO SHEETS A3.08 & A3.09 FOR PARTITION TYPES, GRAPHIC AND SYMBOLIC DESIGNATIONS, NOTES AND DETAILS.
- REFER TO SHEETS A3.10 & A3.11 FOR INTERIOR EXPANSION JOINT DETAILS.
- REFER TO SHEETS A3.10 & A3.11 FOR MISCELLANEOUS METAL FABRICATION (MF) TYPES AND DETAILS.
- REFER TO SHEET A3.20 FOR TYPICAL TOILET LAYOUTS, TOILET ACCESSORY MOUNTING DIAGRAMS, AND LOCKER TYPES AND SCHEDULE.
- REFER TO SHEET A3.25 FOR SHOWER DETAILS.
- REFER TO SHEETS A3.31 - A3.38 FOR DOOR INFORMATION, SCHEDULES, AND DETAILS.
- REFER TO SHEETS A3.40 - A3.43 FOR FINISH INFORMATION AND SCHEDULES.
- REFER TO SHEETS A3.51 & A3.52 FOR CASEWORK INFORMATION AND DETAILS.
- REFER TO SHEET A3.53 FOR MILLWORK DETAILS.
- REFER TO SHEETS A3.8050 - A3.8065 FOR COMMON PROJECT-WIDE DETAILS.
- REFER TO SHEETS A3.8100 - A3.8800 FOR LEVEL-SPECIFIC DETAILS.
- REFER TO SHEETS A7.90 - A7.92 FOR BOWL RAILING DETAILS.
- REFER TO SHEETS A8.00 - A8.40 FOR STAIR, ELEVATOR, ESCALATOR AND RAMP PLANS SECTIONS AND DETAILS.
- REFER TO A7 TO SHEET SERIES FOR SUITE GLAZING SCHEDULE AND DETAILS.
- ALL ANGLED CONDORSE WALLS ARE DIMENSIONED TO THE INTERIOR VERTICAL FACE.
- REFER TO SHEET A3.45 FOR TV MATRIX; PLAN DESIGNATIONS CORRELATE TO THE SPECIFIC ROOM NUMBER.

ALL OVERALL SHEETS REISSUED FOR COORDINATION AND REFERENCE

HATCHED AREA (FROM CCD-045) HAS BEEN REMOVED. ALL AREAS ARE SHOWN FOR CONSTRUCTION.
 TRUE NORTH
 PLAN NORTH

**02 TRASH / RECYCLE ROOM**  
1/8" = 1'-0"

**01 EVENT LEVEL - SECTOR 04**  
1/8" = 1'-0" EL = 100'-0"